

Friarswood FW100

DAB+ / DAB / FM Radio



User Manual



This manual is available to download online at www.azatom.com

Thank you for shopping with **AZATOM®** Please read this manual carefully before using your new device and keep it safe for future reference.

AZATOM® is a British company specialising in advanced audio products. All our products are developed by our In-house Team of British Designers.

We are experts in sound engineering and great care and attention goes into the design and manufacture of every **AZATOM®** product to ensure class-leading performance and quality.

Please read the manual thoroughly before operating the device.

Choose a suitable location for the device. Suitable locations are dry, even and anti-slip surfaces on which you may operate the device easily.

Make sure there is proper ventilation for the device.
Remove, if necessary, the protection sheet from the display.

This product was designed to be all placed all around your home, all while delivering high quality audio.



Contents

Section:	Page:
Controls & Interface.....	1
What's In The Box / Performing Radio Scans.....	2
Using the Friarswood FW100.....	3
Setting the Alarm.....	4
Setting the Date and Time.....	6
Setting the Backlight Brightness.....	7
Using EQ.....	8
Connecting Via Bluetooth.....	9
Language / Factory Reset / Software Version.....	10
Technical Specifications.....	11
Important Safety Information.....	12

Controls & Interface

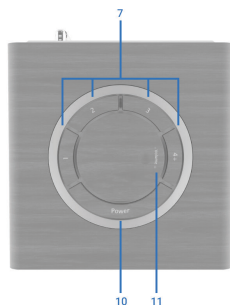
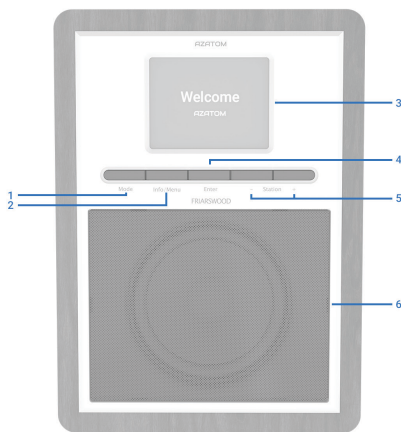

1. **Mode**
2. **Info/Menu**
3. **Display**
4. **Enter**

5. **Station + and -**
6. **Speaker**
7. **Preset Numbers**
8. **DC Power In**

9. **Earphone Port**
10. **Power Button**
11. **Volume / Rotary Button**

What's in the box?

- **AZATOM® Friarswood FW100**
- **User Manual**
- **Power Adapter**
- **AZATOM® Warranty Card**

Performing Radio Scans

Scanning for Stations

DAB and FM:

1. Press and hold the Info/Menu button
2. Use the rotary button to scroll down to "Full Scan"
3. Press "Enter" to confirm and perform a DAB and FM Radio Scan

This will automatically store all stations found by the radio within signal range.

FM Mode:

In FM Mode press and hold the Info/Menu button then use the rotary button to scroll down to "Scan Settings"

You can then choose to show "Strong Stations Only" which will show only those with a strong signal or choose to view "All Stations" which will show weaker signal stations.

It is always a good idea to prune (remove) weak or redundant stations - to do this choose the "Prune Invalid" option in the menu settings for DAB mode.

Using the Friarswood FW100

Storing DAB / FM Presets

To store presets you need to select the station you would like to store using the STATION – / + buttons, then hold down one of the preset number button on the top of the unit “1 / 2 / 3 / 4+” for 1-2 seconds until “Save to Preset” is shown on the display.

You then use the rotary button to choose which preset number you would like to save the channel in between 1-20 and use ENTER button to store the station in the desired preset location.

Selecting a Preset Station

To Recall presets press one of the preset number buttons on the top of the unit “1 / 2 / 3 / 4+”, Preset Recall is shown on the display. You can scroll through the Saved presets by using the rotary button.

To select a preset station to listen to press the ENTER button.

Set Sleep Timer

Sleep options: Sleep Off | 15 | 30 | 45 | 60 | 90

1. Press and hold the MENU button to enter the menu.
2. Turn the rotary button to choose System Settings and press ENTER button to confirm.
3. Turn the rotary button to choose Sleep and press ENTER button to confirm.
4. Turn the rotary button to select and press ENTER button to confirm the change of particular option, and start count down.

Setting the Alarm

Alarm Setting

There are two alarms that can be used for the system. You can set the alarm in the DAB mode or FM mode.

1. Press and hold the MENU button to enter the menu. Turn the rotary button to choose "System Settings" and press ENTER button to confirm.
2. Turn the rotary button to choose Alarm and press ENTER button to confirm.
3. Turn the rotary button to choose Alarm 1 or Alarm 2, and press ENTER button to confirm.
4. Now you can see a list of selection, turn the rotary button to choose and press ENTER button to enter the change of particular option:

Option 1:

4.1 Alarm On/ Off

Press ENTER button to choose On or Off directly.

4.2 Frequency

Turn the rotary button to choose below options and press ENTER button to confirm.

*Daily / Weekends / Weekdays => go to 4.3 option 1

*Once => go to 4.3 Option 2

4.3 Option 1: Wake Up time

4.3.1. Press ENTER button and the Hour part will flash. Press STATION - / + button to set the hour for alarm, press ENTER to confirm.

4.3.2. The Minute part will flash. Press STATION - / + button to set the minute for alarm, press ENTER to confirm.

Option 2:

Date/Time

4.3.3. Press ENTER button and the Day part will flash. Press STATION - / + button to set the day for alarm, press ENTER to confirm.

4.3.4. The Month part will flash. Press STATION - / + button to set the month for alarm, press ENTER to confirm.

4.3.5. The Year part will flash. Press STATION - / + button to set the year for alarm, press ENTER to confirm.

4.3.6. The Hour part will flash. Press STATION - / + button to set the hour for alarm, press ENTER to confirm

4.3.7. The Minute part will flash. Press STATION – / + button to set the minute for alarm, press ENTER to confirm

4.4 Source

Press STATION – / + button to choose below options and press ENTER button to confirm.

*Buzzer => go to 4.5

*Digital Radio / FM => go to 4.6 Preset

4.5 Duration

Press STATION – / + button to choose below options and press ENTER button to confirm. These can be either 15 / 30 / 45 / 60 / 90 / 120 minutes

4.6 Preset (Last Listened)

4.7 Volume

Press STATION – / + button to increase or decrease the Volume from 9 to 32 max.

4.8 After completing the settings, press MENU button back to the System Settings. Turn the rotary button to choose Alarm, and press ENTER button to enter.

4.9 Now you can see the status of the Alarm 1 and Alarm 2. It shows On or Off, and time on the left. During the process of setting the alarm, you can press MENU button once exit to System Settings without Saving.

5. Alarm ringing

When the alarm is ringing, it will enter standby mode if the sound source you selected was Buzzer.

If the sound source you selected was DAB or FM station, the radio will go to that station automatically.

The volume will increase gradually to reach the level you have set.

6. Stop the alarm

You can stop the alarm by press POWER button.

The screen will show Alarm off. The radio will go to standby mode.

7. Snooze function

You can also press ENTER button to Snooze function.

The alarm will temporarily stop, exit to standby mode and go Snooze function.

It will show the snooze time. You can set the snooze time to 5 or 10 minutes by press ENTER button continuously until you see the correct time.

Then the radio will temporary stop and exit to standby mode.

When the radio start playing again, you can press the ENTER button to stop it

Set Time/Date

1. Press and hold the MENU button to enter the menu. Turn the rotary button to choose "System Settings" and press ENTER button to confirm.
2. Turn the rotary button to choose "Time/Date" and press ENTER button to confirm.
3. Now you can see a list of selection, press STATION - / + button to choose and press ENTER button to enter the change of particular option:

Set time/date

1. Press ENTER button and the Day part will flash. Press STATION - / + button to set the day for alarm, press ENTER to confirm.
2. The Month part will flash. Press STATION - / + button to set the month for alarm, press ENTER to confirm.
3. The Year part will flash. Press STATION - / + button to set the year for alarm, press ENTER to confirm.
4. The Hour part will flash. Press STATION - / + button to set the hour for alarm, press ENTER to confirm.
5. The Minute part will flash. Press STATION - / + button to set the minute for alarm, press ENTER to confirm.

Auto Update

Press the STATION - / + button to choose the time update source <from any> / <from Digital Radio> / <from FM> / <No update >, and press ENTER button to confirm.

Set 12 / 24 Hour

Press STATION - / + button to choose <12 Hour> / <24 Hour> for time display, and press ENTER button to confirm.

Set date format

Press STATION - / + button to select <DD-MMYYYY> / <MM-DD-YYYY> for date display format, and press ENTER button to confirm.

Set the Backlight Brightness

This radio display has a backlight with adjustable time-out (this is the time delay, in seconds, after which the display switches off).

1. Press and hold the MENU button to enter the menu. Turn the rotary button to choose "System Settings" and press ENTER button to confirm.
2. Press STATION – / + button to choose Backlight and press ENTER button to confirm.
3. Now you can see a list of selection, press STATION – / + button to choose and press ENTER button to enter the change of particular option:

3.1 Time-out options:

This can be set to either 10 / 20 / 30 / 45 / 60 / 90 / 120 / 180 second.

In the Backlight menu, press STATION – / + button to select a particular options and press ENTER button to confirm.

3.2 On Level (when you listening radio)

This can be set to either High / Medium / Low

In the Backlight menu, press the STATION – / + button to select a particular option and press ENTER button to confirm.

3.3 Dim Level (standby mode)

This can be set to either High / Medium / Low

In the Backlight menu, press the STATION – / + button to select a particular option and press ENTER button to confirm.

Using EQ

1. In your desired mode, Press and hold the INFO/MENU button until the main menu opens.
2. Using the - VOLUME + dial, scroll down to "System Settings" and press enter
3. Using the - VOLUME + dial, scroll down to "Equaliser" and press enter
4. From this menu you can choose a preset EQ setting based on the type of music you are listening to, For example: Rock, Jazz, Pop and so on.

Alternatively you can create your own EQ setting by selecting "My EQ" from the "Equaliser" menu. This allows you to individually control the Treble, Bass and Loudness. Once your settings have been selected press "INFO/MENU" to save and return to the previous menu page.

Connecting via Bluetooth

1. Press the "MODE" button until BLUETOOTH is selected

If this is the first time you're connecting to the Friarswood Bluetooth connection the display will show "Disconnected" - If a device has previously been connected to the Friarswood Via Bluetooth, Press and hold "Enter" to disconnect any devices. If the display shows "Connected" and you've previously connected the device you'd like to play music from, resume audio output from your music playing device and skip steps 2 and 3.

2. With the display showing "DISCONNECTED" open the Bluetooth setting on your audio playing device you wish to connect to the Friarswood Speaker, and search for new Bluetooth devices.

3. Select the Friarswood from the list of available devices

You're now connected to the Friarswood speaker, for any additional help with playing audio - please refer to your audio players manual for output selection via Bluetooth.

Set Your Language

1. Press and hold the MENU button to enter the menu. Turn the rotary button to choose "System Settings" and press ENTER button to confirm.
2. Press STATION – / + button to choose Language and press ENTER button to confirm.
3. Now you can see a list of selection, press STATION – / + button to choose and press ENTER button to enter the change of particular option:

Options: English / French / Dutch / Italian

Factory Reset

A factory reset clears all user defined settings, replacing them with the original default values, so time/date, preferences/settings, DAB station list and preset stations are all lost.

If you select Factory reset, you are asked to confirm by selecting YES.

1. Press and hold the MENU button to enter the menu. Turn the rotary button to choose "System Settings" and press ENTER button to confirm.
2. Press STATION – / + button to choose "Factory Reset" and press ENTER button to confirm.
3. Now you can see a list of selection, press CHANNEL button to choose and press ENTER button confirm.

SW Version (Software Version)

This displays the current software version.

1. Press and hold the MENU button to enter the menu. Turn the rotary button to choose "System Settings" and press ENTER button to confirm.
2. Press STATION – / + button to choose "Software Version" and press ENTER button to confirm.

Technical Specifications

Power requirement mains (via adaptor):	AC 100-240V, 50/60Hz
Frequency Coverage:	FM: 87.5-108MHz DAB: 174.928 - 239.200MHz
Circuit Features	
Loudspeaker:	1x 75mm Full-Range Drivers
Output power:	18W (Max Power Output)
Earphone socket:	3.5mm dia. Stereo
Aerial system: FM:	Telescopic Aerial
DAB:	Telescopic Aerial

IMPORTANT SAFETY INFORMATION

1. Read these instructions.
2. Keep these instructions. Instructions are also available for download at www.azatom.com
3. Heed all Warnings.
4. Follow all instructions.
5. Do not clean the apparatus near or with water.
6. Clean only with a dry cloth.
7. Do not block any ventilation openings.
Install in accordance with the manufacturer's instructions.
8. Do not install near any heat sources such as radiators, heat registers, stoves, or other apparatus (including amplifiers) that produce heat.
9. Protect the power cord from being walked on or pinched particularly at plugs, convenience receptacles, and the point where they exit from the apparatus.
10. Only use attachments/accessories specified by the manufacturer.
11. Unplug this apparatus during light storms or when unused for long periods of time.
12. Refer all servicing to qualified service personnel.

Servicing is required when the apparatus has been damaged in any way, such as power supply cord or plug is damaged, liquid has been spilled or objects have fallen into the apparatus, the apparatus has been exposed to rain or moisture, does not operate normally or has been dropped.

13. No naked flame sources, such as lit candles, should be placed on the apparatus.
14. Dispose of used electrical products and batteries safely according to your local authority and regulations.

ADDITIONAL WARNINGS

The apparatus shall not be exposed to dripping or splashing and no objects filled with liquid, such as vases, shall be placed on apparatus.

Main plug is used to disconnect device and it should remain readily operable during intended use. In order to disconnect the apparatus from the main mains completely, the mains plug should be disconnected from the main socket outlet completely.

Battery shall not be exposed to excessive heat such as sunshine, fire or the like.

RECYCLING ELECTRICAL PRODUCTS

You should now recycle your waste electrical goods and in doing so help the environment.



This symbol means an electrical product should not be disposed of with normal household waste. Please ensure it is taken to a suitable facility for disposal when finished with.



IMPORTANT: Please read all instructions carefully before use and keep for future reference



- Risk of electric shock.
Do not open



- Read all instructions carefully before use and keep for future reference.



- When servicing, use only identical replacement parts.



AZATOM[®]
ADVANCING AUDIO TECHNOLOGY

www.azatom.com



Azatom



@Azatom.Online



@Azatom

REGISTER YOUR PRODUCT ONLINE FOR THE AZATOM WARRANTY

TO LEARN MORE & REGISTER FOR THE AZATOM WARRANTY PLEASE VISIT
WWW.AZATOM.COM/WARRANTY

*REGISTRATION REQUIRED
AZATOM[®] 2018 ALL RIGHTS RESERVED. AZATOM[®] IS PART OF THE 4COOL TECHNOLOGY LTD.

AZATOM[®] & 4COOL TECHNOLOGY LTD. RESERVE THE RIGHT TO WITHDRAW ANY AND ALL PROMOTIONS WITHOUT NOTICE. FOR FULL WARRANTY, EXTENDED WARRANTY AND PROMOTIONAL OFFER TERMS & CONDITIONS PLEASE VISIT WWW.AZATOM.COM/TERMS-CONDITIONS